

PRODUCT SPECIFICATION SHEET

**ITEM # YY-EZ-TM**

**TRIM**

**Wall mount volume control**

- "EZ" style handle
- For SASTOP12, SASTOP34, SA-CORNER-SET

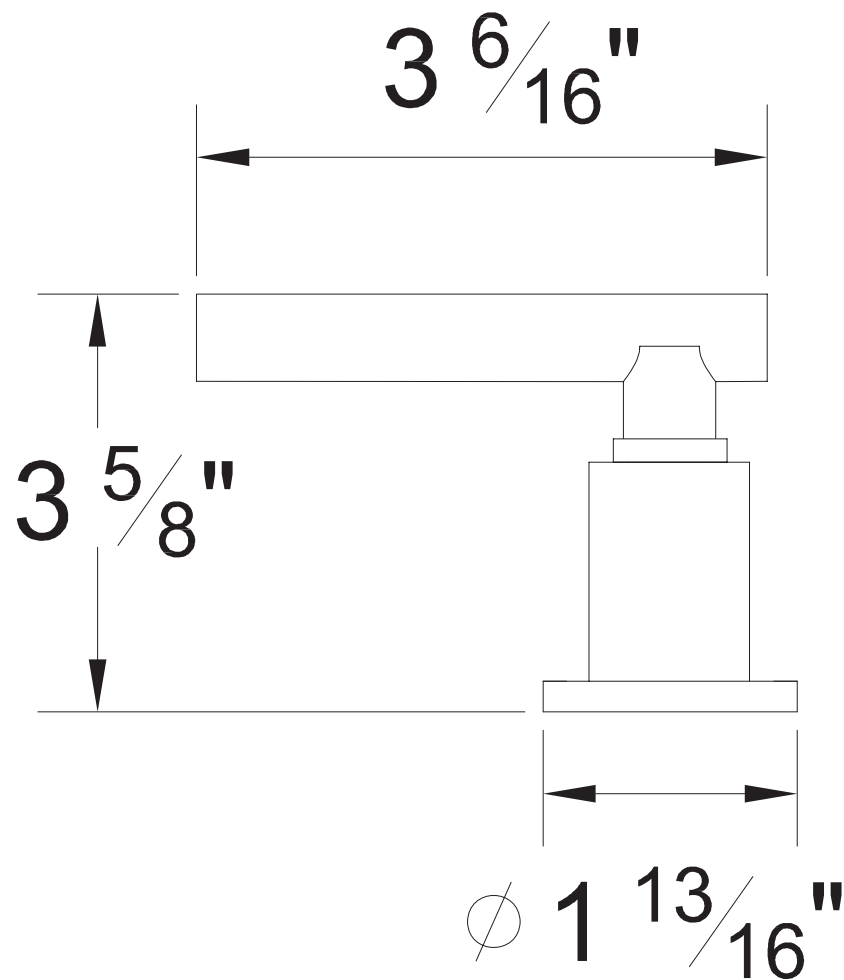

The measurements shown are for reference only. Products and specifications shown are subject to change without notice.

[www.santecfaucet.com](http://www.santecfaucet.com) | P: 310.542.0063 F: 310.542.5681