



Cortez™ Light Fixture™

A Kichler® Décor™ Ceiling Fan

Designed to coordinate with a popular Kichler Décor Ceiling Fan.

KICHLER
LIGHTING 

Kichler® Lighting
7711 East Pleasant Valley Road
P.O. Box 318010
Cleveland, Ohio 44131-8010

Customer Service
866.558.5706
8:30 AM to 5:00 PM EST,
Monday - Friday

Instruction Manual

KICHLER
LIGHTING 

"CAUTION-RISK OF FIRE"
CONSULT A QUALIFIED ELECTRICIAN TO
ENSURE CORRECT BRANCH CIRCUIT
CONDUCTOR.

1. SAFETY RULES

WARNING! RISK OF ELECTRIC SHOCK

All electrical connections must be in accordance with local codes, ordinances, or national electrical codes. If you are unfamiliar with methods of installing electrical wiring, secure the services of a qualified electrician. Before starting installation, disconnect the power by turning off the circuit breaker or removing the fuse at fuse block. Turning power off using fan switch (speed control on/off) is not sufficient to prevent electrical shock.

NOTE: The important safeguards and instructions appearing in this manual are not meant to cover all possible conditions and situations that may occur. It must be understood that common sense, caution and care are factors which cannot be built into any product. These factors must be supplied by the person (s) caring for and operating the unit.

2. INSTALLING THE LIGHT KIT

Step 1. Remove the finial NUT located in the center of the switch housing. See Figure. 1

Step 2. Remove the hex nut and lock washer from the light fixture mounting stem. (Fig. 1)

Step 3. Feed the electrical wires from the light fixture through the hole in the switch housing (starting with the black wire first, it has a larger connector). Feed the two pull chains from switch housing through the holes on each side of the light kit. Threaded the light kit onto the switch housing, add the lock washer and hex nut on the inside of the switch housing and tighten securely. (Fig. 2)

Step 4. Connect the black wire connectors from the light fixture and switch housing by pushing them together. Follow the same procedure with the white wire connectors. (Fig. 2)

Step 5. The square plastic wiring connector from the ceiling fan and the light fixture will only fit together one way. Match up the color on the side of each connector, then push them together until the snap engages. (Fig. 3 on the next page)

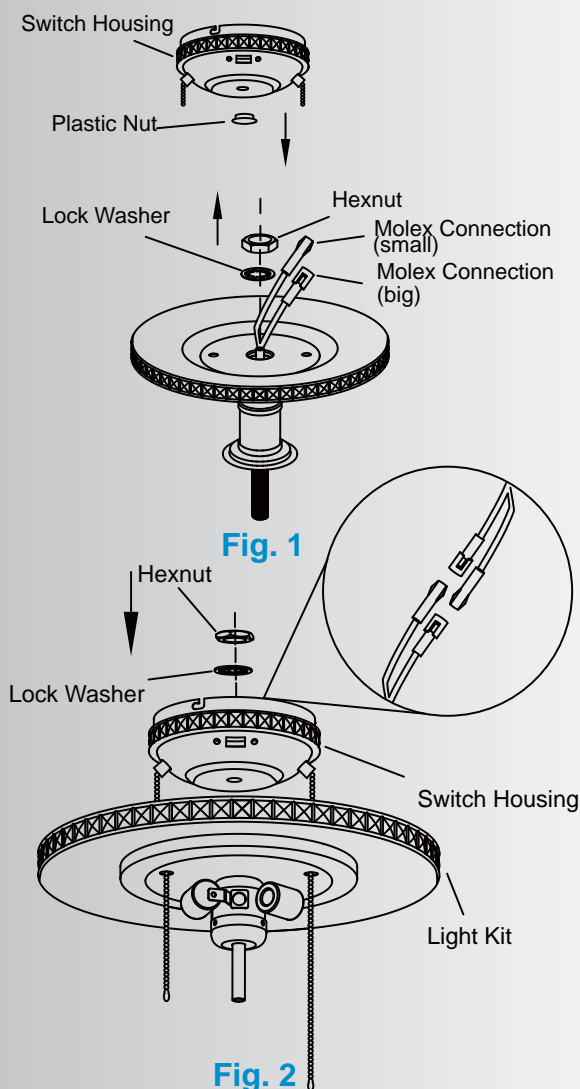

Step 6. Tuck the connections neatly into the switch housing. Align the key holes on the switch housing with the 2 screws on the side of the mounting plate. Turn the light fixture until it locks in place at the narrow end of the key holes. Reinstall the screw you removed and tighten the 2 other screws. Now, install 3, 40 watt candelabra base lamps (not included) in the light fixture. (Fig. 4)

Step 7. Feed the two (2) pull chains from light kit through the holes in the center of glass shade. Now secure the glass shade to the fixture by fitting it up securely to the light kit. Secure the glass shade with the washer (rubber against the glass), metal washer and manual nut. (Fig. 5)

Step 8. Feed each of the pull chains through the appropriate holes on the decorative cap, then place decorative cap against the underside of the glass and attach the finial nut snug but do not over tighten.

Step 9. Attach a decorative fob to the pull chain. (Fig. 5)

NOTE: The LONGER pull chain is for motor speed control and it has four positions. High, Medium, Low and Off. Pulling the Fob once for each position. The SHORTER pull chain is for light control, pull for ON or OFF.

NOTE: With the optional light installed, the pull chain functions as follows.

- * One pull on the chain turns the UP Light ON.
- * Second pull on the chain turns the UP Light OFF and the DOWN Light ON.
- * Third pull on the chain turns BOTH the UP and the Down Light ON.
- * Fourth pull on the chain turns BOTH Lights OFF.

NOTE: Reversing the direction of the ceiling fan blades is controlled by a horizontal "Slide Switch" located on the side of the switch housing.

Your New Kichler Ceiling Fan is now ready to use. Remember to RESTORE all power.

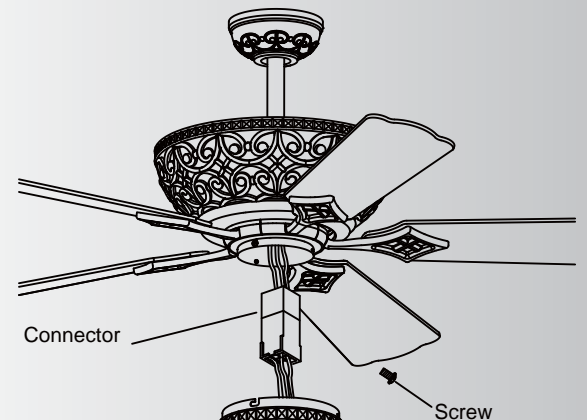

Fig. 3

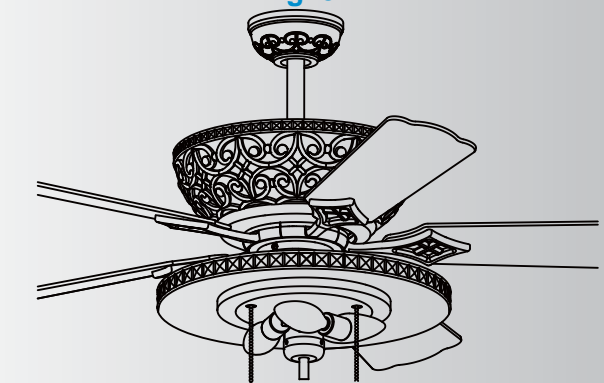

Fig. 4

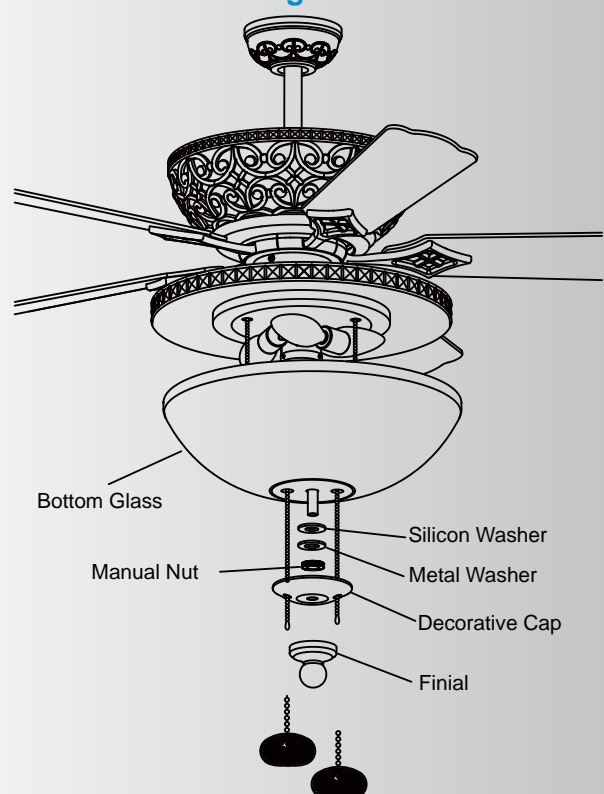

Fig. 5