



California Faucets®

SHOWER

Handshower supply elbow

Features

- Over 30 finishes including 14 PVD finishes
- Solid brass construction
- All mounting hardware included
- Accepts most conical handshower hoses

Codes/Standards Applicable

Meets or exceeds the following at date of manufacture:

- ASME A112.18.1/CSA B125.1

SH-20-38

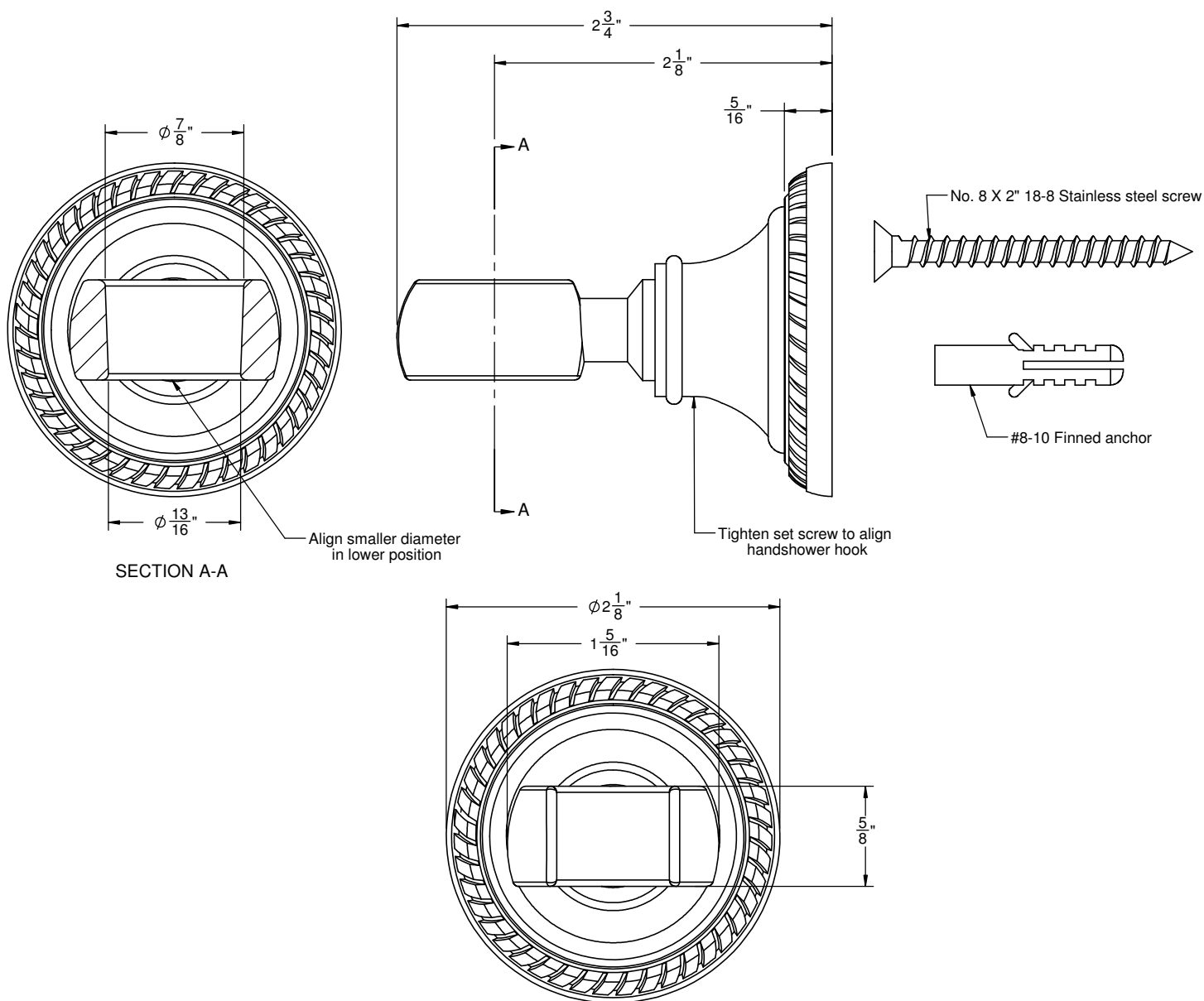
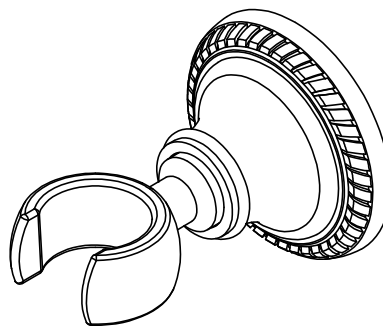

ALL DIMENSIONS SHOWN TO NEAREST 1/16"



California Faucets®

SHOWER

Handshower supply elbow

Features

- Over 30 finishes including 14 PVD finishes
- Solid brass construction
- 1/2" NPT (female) inlet connection
- 1/2" NPSM (male) outlet connection

Codes/Standards Applicable

Meets or exceeds the following at date of manufacture:

- ASME A112.18.1/CSA B125.1

SH-10-38

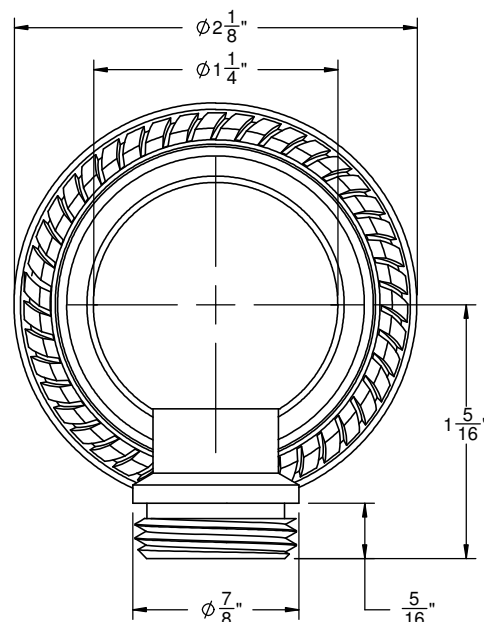
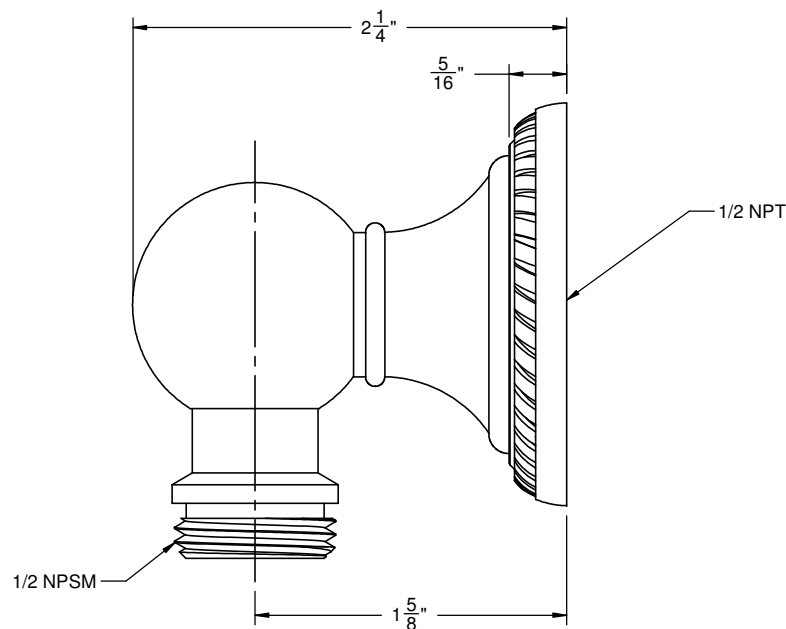
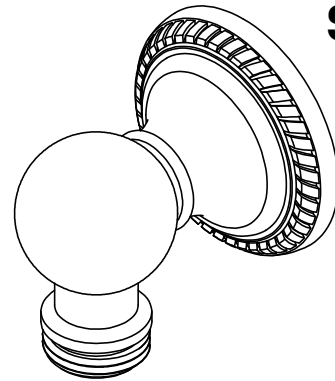

ALL DIMENSIONS SHOWN TO NEAREST 1/16"