



California Faucets®

DIVA

TUB SPOUT

Features

- Over 30 finishes including 14 PVD finishes
- Solid brass construction
- 5-1/2" to center
- 1/2" FIP inlet at rear of spout
- 16 gpm (60.6 L/m) maximum flow rate
- For use with StyleTherm, 3-VR or 2-VR valves
- For additional product offerings, see www.californiafaucets.com

Codes/Standards Applicable

Meets or exceeds the following at date of manufacture:

- ASME A112.18.1/CSA B125.1

TS-E2

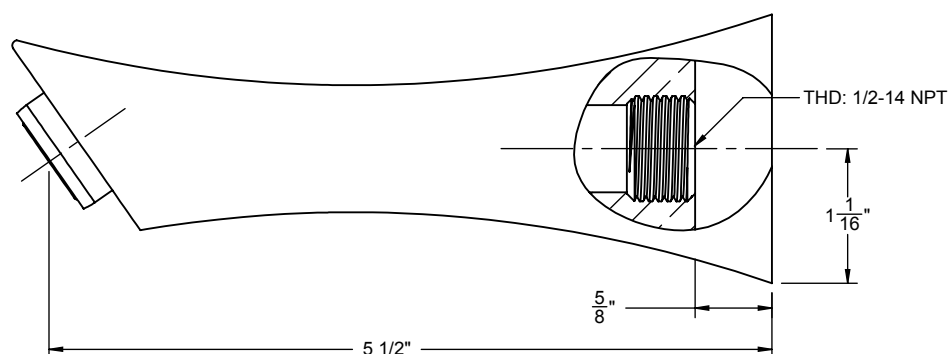
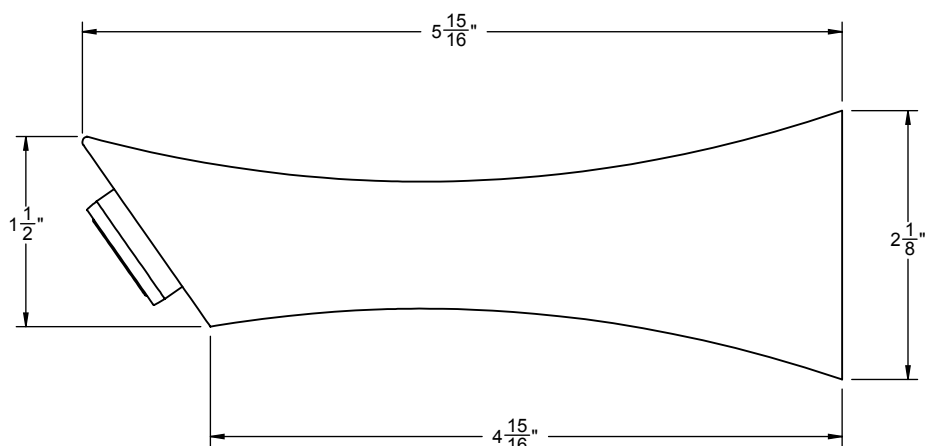
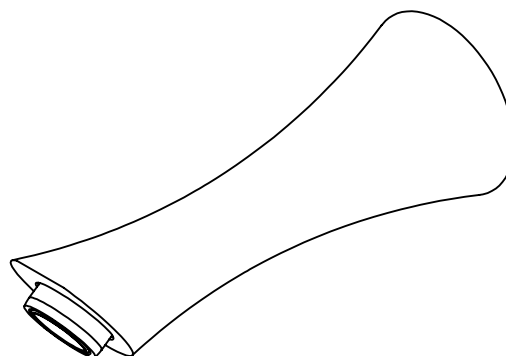

ALL DIMENSIONS SHOWN TO NEAREST 1/16"