

*Please read the instructions completely before beginning the installation.*

**Rough**  
**Pressure balanced control valve**  
Model Number: PB-3800

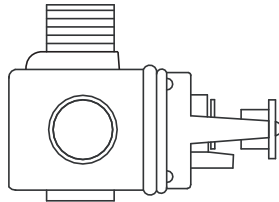

## INSTALLATION INSTRUCTIONS

**Warning:** Failure to follow these instructions, or improper operation, may damage the valve and void the warranty.

**NOTE:** Do not remove the plastic cover template until mounting the trim.

- Determine where the finished wall will be. This measurement is necessary to accurately plumb in the valve.
- Install valve into the wall using min/max adjustment limits on the plastic cover template.
- Completely flush the lines of all dirt and debris prior to installing the valve to the supply lines.
- Connect the HOT water supply to the left inlet of the valve and COLD supply to the right inlet of the valve.
- Secure valve position in the wall using min/max adjustment limits. For backset measurements, see Diagram B.
- Connect the outlet pipe to shower connections.
- Test for proper function before closing walls. Do this by pressurizing both HOT and COLD lines.

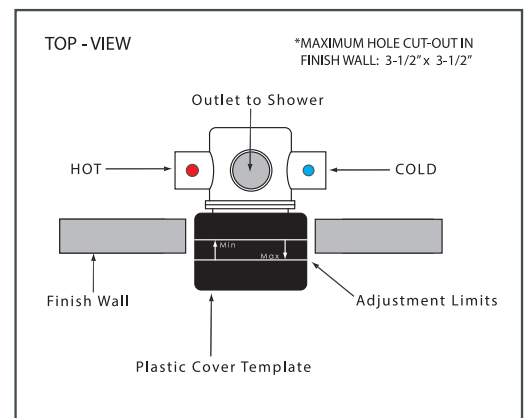

Diagram A

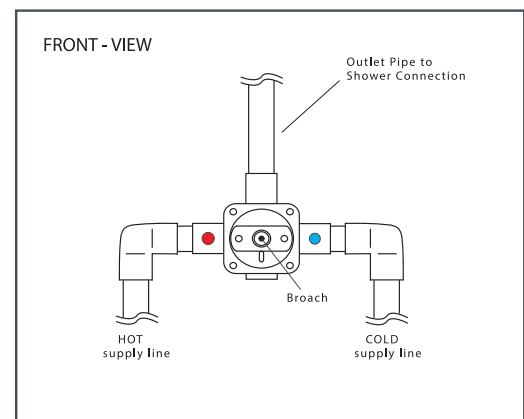

Diagram B

The measurements shown are for reference only. Products and specifications shown are subject to change without notice.

www.santecfaucet.com | P: 310.542.0063 F: 310.542.5681

## Temperature Stop Set up

Step 1 - Remove all handle trim parts, including the trimplate.

Step 2 - Remove all rough parts including the all-thread, stem key and lock plate.

Step 3 - Make sure the valve is fully turned clockwise. Install the mechanical stop with its left side touching the stop post as shown in Diagram A.

Step 4 - Install the limit stop over the mechanical stop as shown in Diagram B. The limit stop should point between the two S's of the logo TEMPRESS. This is the manufacturers recommended temperature limit. If the user desires a higher temperature than assemble the limit stop counter-clockwise from the manufacturers recommended position.

Step 5 - Reinstall the components of the valve and trim.

Diagram A

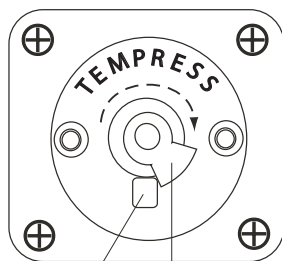

Stop Post

Mechanical Stop

Diagram B

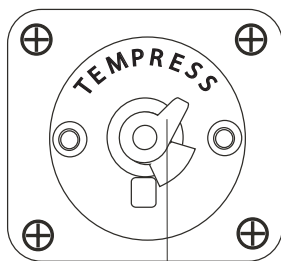

Limit Stop

The valve has filter screens that prevent debris from obstructing the pressure balancing cartridge. If excessive in-line debris accumulates in the filter screen you will notice a decrease in water flow. Please refer to the instructions below and Diagram A & B above.

Step 1 - Remove all handle trim parts, including the trimplate.

Step 2 - Remove the all-thread, stem key, lock plate, limit stop, and mechanical stop.

Step 3 - Remove the 4 screws holding the front valve plate to the valve and remove the plate.

Step 4 - Carefully pull out the valve cartridge from inside the valve.

Step 5 - Use your fingernail to pry up the filter inserts on both sides of the valve.

**WARNING:** Using a screwdriver or metallic object to remove the filter inserts will scar the inside of the valve body which may lead to a water leakage.

Step 6 - All debris can now be easily removed from the filter screen by running it under water until clean.

Step 7 - Replace the insert back into the valve body, making sure the angled edge of the insert faces outward.

Step 8 - Replace the cartridge back into the valve body, making sure that the H is pointed toward the HOT inlet tube and C is facing toward the COLD inlet tube. The H and C letters are stamped on the side of the cartridge.

Step 9 - Reverse the assembly steps 3,2 &1 above.

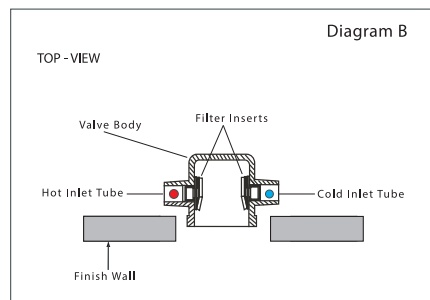
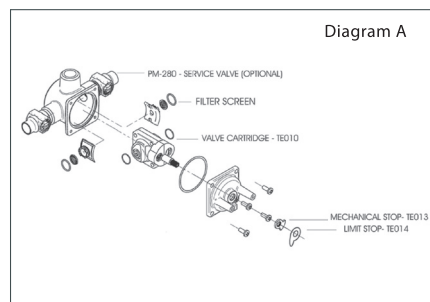

The measurements shown are for reference only. Products and specifications shown are subject to change without notice.

www.santecfaucet.com | P: 310.542.0063 F: 310.542.5681

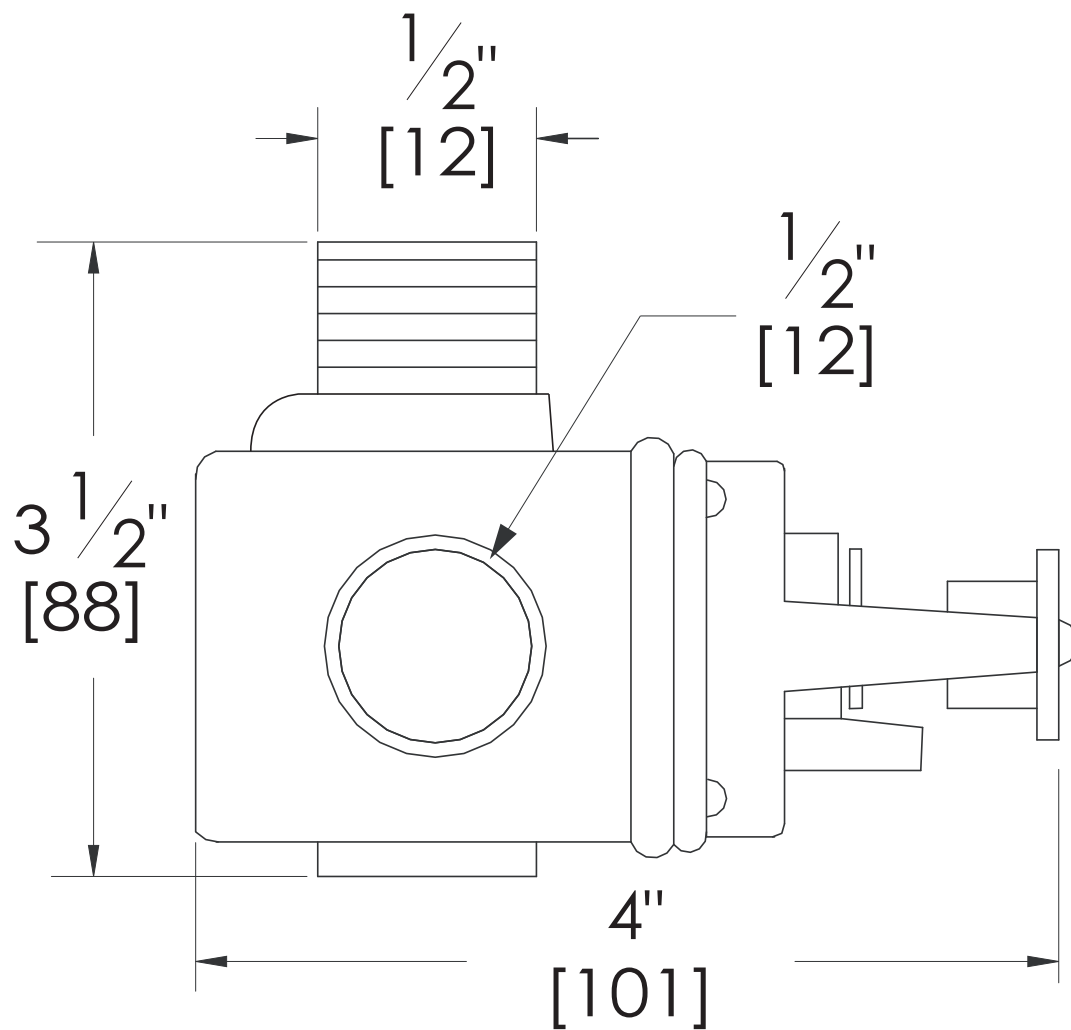



## FINISH CARE INFORMATION

**WARNING:** Do not clean your SANTEC product with ammonia (Window cleaner), bleach, soap, acids, abrasives, harsh polish, harsh cleaners, a coarse surfaced cloth, coarse sponge, or any type of scouring pad. Doing so may ruin your faucet finish and/or void the warranty.

Thank you for making SANTEC a part of your lifestyle and luxury spa experience. Our products have been created as works of enduring quality and sophisticated design.

Luxurious finishes need proper care and attention, so in order to understand how to properly clean your distinctive luxury finish, please refer to the finish care information below:

Your SANTEC product can be identified in one of two categories: clear coated finishes or non-clear coated finishes. Clear coated finishes are more scratch-sensitive and are more reactant to harsh cleaning chemicals than non-clear coated finishes. Once you have identified the specific luxury finish of your SANTEC product, please follow the important corresponding care instructions.

## CLEAR COATED FINISHES

We recommend that all faucets, drains, etc., be gently wiped dry with a soft cloth after use to avoid water spotting and water deposit build-up. A mild liquid hand soap may be used occasionally if desired. Use of a non-abrasive carnauba wax will add protection to the finish and should be used if the faucets will not be dried after use. For clear coated finishes, it is recommended to clean your product weekly with a soft moist cloth.

## NON-CLEAR COATED FINISHES

We recommend that all faucets, drains, etc., be gently wiped dry with a soft cloth after use to avoid water spotting and water deposit build-up. A mild liquid hand soap may be used occasionally if desired. Use of a non-abrasive carnauba wax is occasionally required and will add protection to the finish if the faucets will not be dried after use.

## TO OBTAIN WARRANTY SERVICE

Please read 'WHAT IS COVERED BY OUR WARRANTY' and 'EXCLUSIONS AND LIMITATIONS OF WARRANTY' sections to understand what is and what is not covered. Please have ready the proof of purchase (original sales receipt), description of the problem, and carefully package the product or defective part with postage prepaid. Then, please contact your local SANTEC Showroom or write to SANTEC Technical Services.



## LIFETIME LIMITED WARRANTY

SANTEC is committed to enhancing your bathroom experience by creating luxury products that will provide enduring satisfaction. Every effort has been made to satisfy the highest standards of design and production, to create lasting peace of mind for our customers. We provide the following limited warranties on our products:

## LENGTH OF WARRANTY & WHO IS COVERED BY OUR WARRANTY

This warranty extends to the original consumer purchaser only and extends for as long as the original purchaser owns the product and the home in which the product is installed.

## WHAT IS COVERED BY OUR WARRANTY

1. **FINISHES:** SANTEC Polished Chrome, Polished Nickel and Satin Nickel finishes carry a Lifetime Limited warranty against manufacturing defects and tarnish to the original purchaser. All other finishes carry a ten (10) year limited warranty against manufacturing defects and tarnish to the original purchaser only.
2. **CARTRIDGES:** Santec cartridges carry a lifetime limited warranty, with the exception of thermostatic and pressure balanced cartridges, which carry a three (3) year limited warranty against manufacturing defects to the original purchaser.
3. **PARTS:** Santec parts carry a 10-year limited warranty against manufacturing defects, to the original purchaser.

## EXCLUSIONS & LIMITATIONS OF WARRANTY

This warranty does not cover:

1. Damage due to negligence, accident, abuse, improper installation, or improper maintenance such as, but not limited to: heat from soldering during installation, the use of plumber's putty, damage from tools used during installation, the use or exposure to chemicals or cleaning products either abrasive or non-abrasive, or the use of any cleaning tool or product other than a soft, clean cloth. Reverse osmosis may also shorten the life of the finish.
2. Changes in the finish or in the product due to normal wear or aging does not cover any products or parts which have been altered or used in a manner not typical for the product.
3. Loss, damages, or expense, incidental or consequential whatsoever, originating from the purchase, installation, use, repair, failure, or replacement of any SANTEC product or part, allowed by law.
4. Commercial and/or Industrial installations and use of the product.
5. This warranty does not include labor, travel charges, or any costs incurred for repair, removal, installation, servicing, diagnosing, or handling of either defective or replacement parts.
6. Damage or deterioration caused by environmental impacts.

SANTEC reserves the product components of the covered product will be repaired, refinished, or replaced at the sole discretion of SANTEC. SANTEC reserves the right to examine any product claimed defective prior to any warranty claim being accepted or processed, at its sole discretion. This warranty gives you specific legal rights and you may have other rights which may vary from state to state.

---

The measurements shown are for reference only. Products and specifications shown are subject to change without notice.

[www.santecfaucet.com](http://www.santecfaucet.com) | P: 310.542.0063 F: 310.542.5681