

Professional Series PSX1102112 Stainless Steel |

122.0191.480

FAMILY : **Sinks** | SERIE : **Professional Series** | MODEL : **PSX1102112** | FINISH : **Stainless Steel** | INSTALLATION TYPE : **Undermount** | STYLE : **Contemporary**

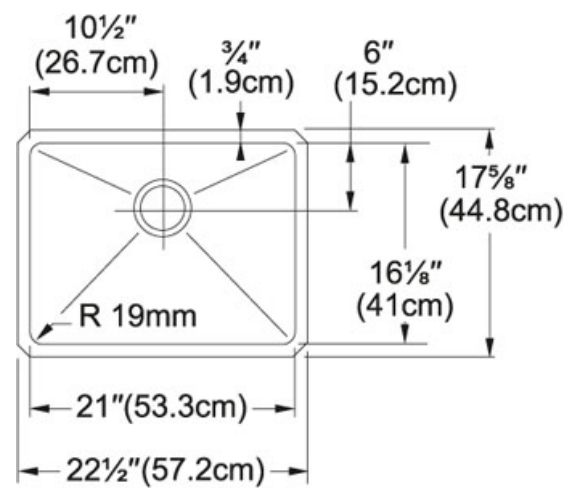

Professional Series sinks are undermounted for an immaculate countertop. If an authentic restaurant kitchen is your fancy, the Professional Series is the real thing. It is designed with sturdy commercial-grade stainless (16-gauge) and is deep enough to accommodate the bulky equipment used by the serious cook.

TECHNICAL DATA	
Minimum Cabinet Size	27"
Length overall	22 1/2"
Width overall	17 5/8"
Length of large bowl	21"
Width of large bowl	16 1/8"
Depth of large bowl	11 7/16"
Number of Bowls	1
Type of Material	16 Gauge Stainless Steel
Cut-Out Template	Yes
Installation Clips	Yes
Where to buy	Showroom
Where to buy	Showroom

Professional Series PSX1102112 Stainless Steel |  
122.0191.480

FAMILY : Sinks | SERIE : Professional Series | MODEL : PSX1102112 | FINISH : Stainless Steel | INSTALLATION TYPE : Undermount | STYLE : Contemporary

RECOMMENDED



115.0190.774



120.0296.741



119.0068.281



134.0297.202



133.0171.120



119.0066.616