



MODEL NUMBER

4150BL10-TM 4150BL23-TM

4150BL41-TM 4150BL75-TM

ESTATE SERIES BRITANI COLLECTION

ROMAN TUB FILLER TRIM WITH “BL” HANDLES

PLEASE READ THE INSTRUCTIONS COMPLETELY
BEFORE BEGINNING THE INSTALLATION.

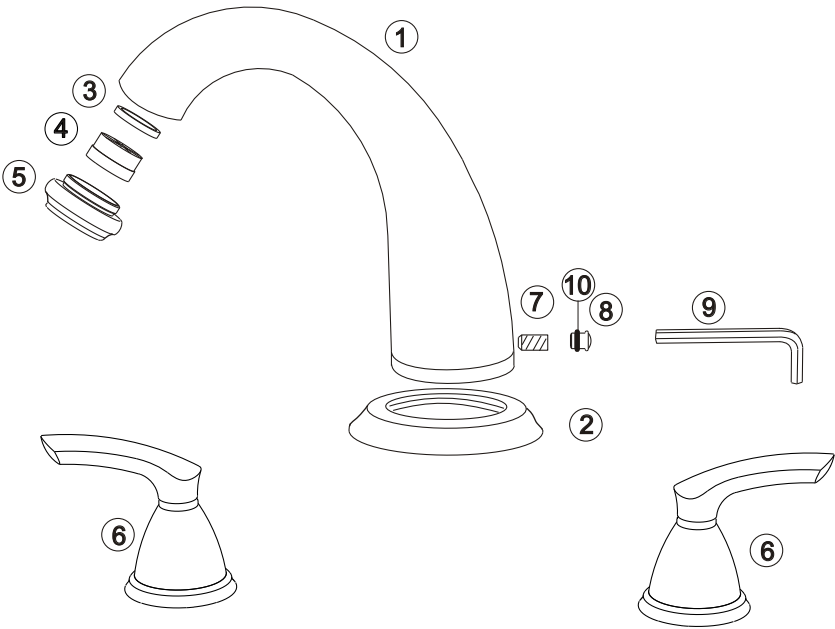

USE ROUGH P0385
(NOT INCLUDED)

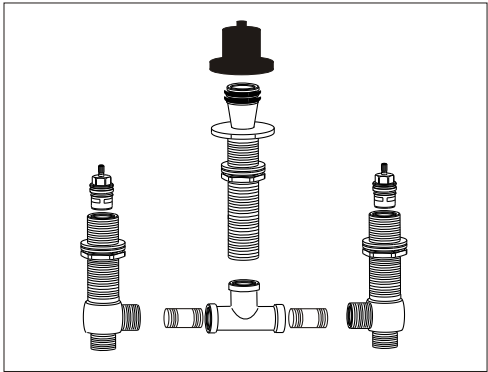

#	PART DESCRIPTION	PART #
1	Complete Spout Assembly *	PS-5K00S
2	Spout Flange *	P0-2065
3	Aerator Washer	PM-356
4	Roman Tub Aerator without Restrictor	PM-355
5	Aerator Housing *	P0931-U
6	Complete BL Lever Handle Assembly *	00BL
7	Set Screw	PM-039
8	Spout Plug	P0-257
9	Allen Key for Roman Tub Spout *	
10	O-ring for the spout plug	PM-445

* Please specify the finish when ordering the part.

INSPECTED BY_____

KEEP THIS INSTRUCTION BOOKLET FOR FUTURE REFERENCE

FLUSH BOTH SUPPLY LINES BEFORE INSTALLATION

AFTER FLUSHING, SHUT OFF BOTH SUPPLY LINES

MINIMUM HOLE SIZE FOR THE SPOUT AND HANDLE TRIM IS 1 1/4" AND MAXIMUM IS 1 1/2"

1. ROUGH INSTALLATION

DO NOT REMOVE THE SPOUT PROTECTANT HOOD PRIOR TO TRIM INSTALLATION

- A** - Install P0285 roman tub rough prior to installing the trims.
(Roughs are sold separately).

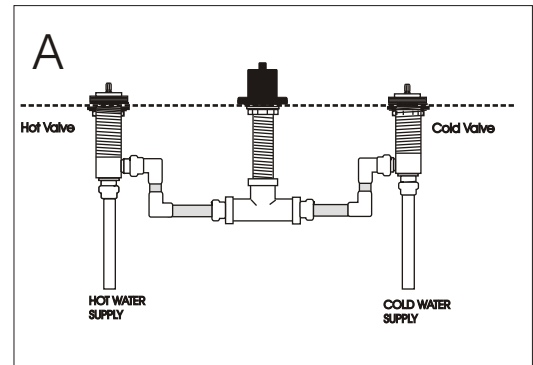

2. SPOUT INSTALLATION

- A** - Remove the faucet from the box.
- From the top of the deck, insert the spout (1) and flange (2) onto the top of quick connect shank.
 - Align the spout and tighten the set screw (7) with the Large Allen Key (9). Insert the spout plug (10) into the spout back hole.

Note: for better installation it is advisable to place silicone caulking around all holes on the top of the deck

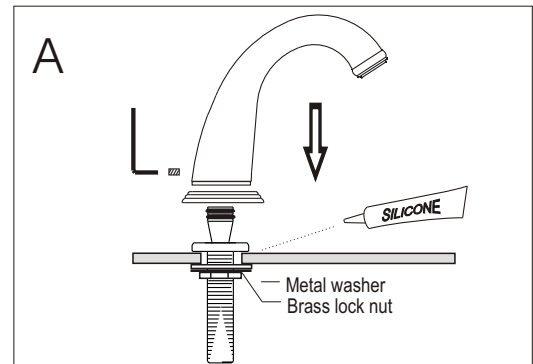

3. HANDLE TRIM INSTALLATION

- A** - Screw the handle trim (6) onto the upper lock nut of installed valve.
- Adjust the handle alignment in respect to the spout.
 - Make sure that the handle turns freely in both direction and tighten the brass lock nut firmly. If the handle is scraping against the stem, lower the valve body to reduce the friction.
 - Repeat the same procedure for the opposite side handle.

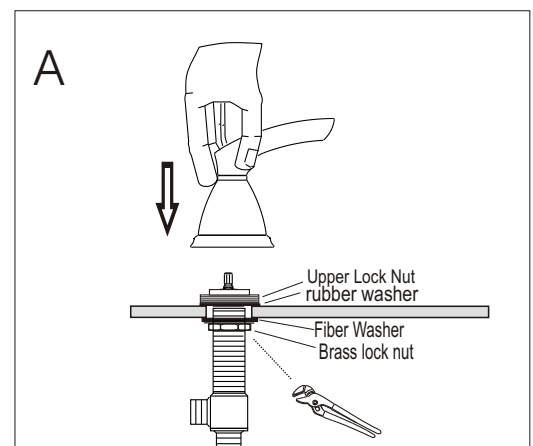

3. FLUSH THE LINE

A - After all the connections have been made, remove the aerator housing (5) basket (4) and washer (3).

- Turn on the water on both hot and cold sides and flush the lines for 45 seconds.
- Turn off the water and reinsert the washer (3), basket (4) and Housing (5).
- Turn on the water and check for leakages at all joints. If water leaks from any of the connections tighten the connection until the leakage stops.

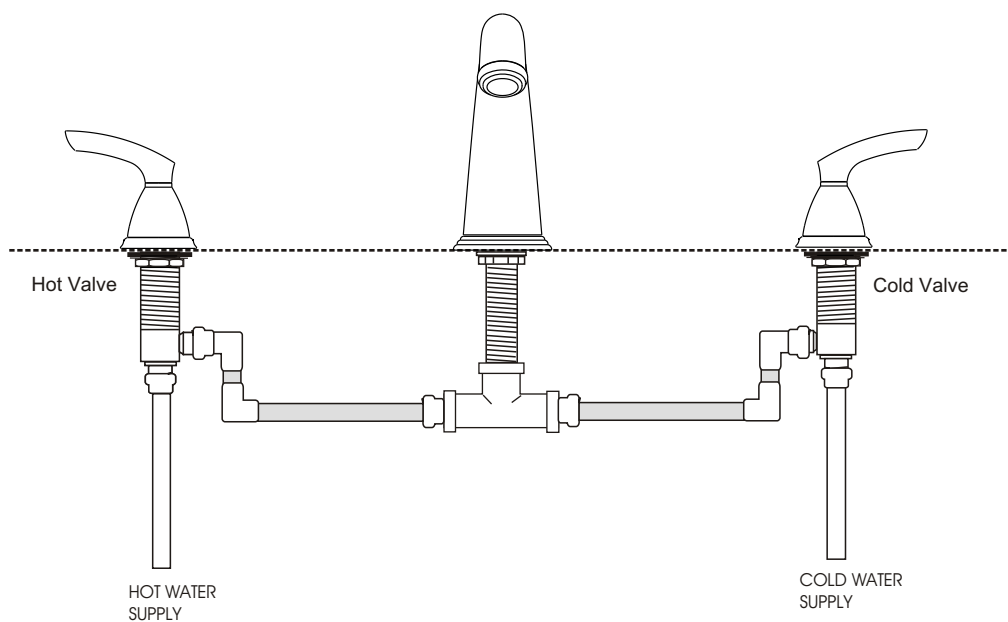
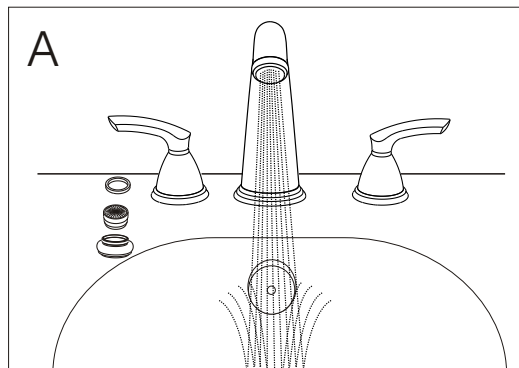

SANTEC LIFETIME LIMITED WARRANTY

1. **Finishes:** Santec **Polished Chrome, Polished Orobrass and Satin Nickel** finishes carry a **Lifetime Limited** warranty against manufacturing defects and tarnish to the original purchaser with the exclusion of kitchen drain assemblies which, due to the nature of their use, are not warranted. Santec **recommended custom finishes** carry a ten (10) years limited warranty against manufacturing defects and tarnish to the original purchaser with the exclusion of kitchen and pop - up drain assemblies which, due to the nature of their use, are not warranted.
2. **Cartridges:** Santec Cartridges carry a lifetime limited warranty against manufacturing defects for the life of the product to the original purchaser.
3. **Parts:** Santec parts carry a Ten (10) year limited warranty against manufacturing defects, to the original purchaser.
4. **Warranty exclusions and limitations :** This warranty does not cover: damage due to negligence, accident, abuse, improper installation, or improper maintenance such as, but not limited to: heat from soldering during installation, the use of plumbers putty, damage from tools used during installation, the use or exposure to chemicals or cleaning products either abrasive or non abrasive or the use of any cleaning tool or product other than a soft, clean cloth. This warranty does not cover: changes in the finish or in the product due to normal wear or aging and does not cover any product or parts which have been altered or used in a manner not typical for the product. **This warranty does not cover and Santec will not be held liable for damage to products caused by the freight carrier and a claim should be made immediately to the freight carrier should this occur.** This warranty does not cover any cost involved in the installation, repair, or replacement of any Santec product or part. This warranty does not cover and Santec will not be held liable for any loss, damages, or expenses, incidental or consequential whatsoever, originating from the purchase, installation, use, repair, failure, or replacement of any Santec product or part, as allowed by law. The product or components of the covered product will either be repaired, refinished or replaced, at the sole discretion of Santec. Santec reserves the right to examine any product claimed defective prior to any warranty claim being accepted or processed, at its sole discretion. This warranty gives you specific legal rights and you may have other rights which may vary from state to state.

Effective **10/01/03** - Replaces and supersedes any previously issued warranty.

FINISH CARE INFORMATION

For clear coated or enamel color finishes:

We recommend that all faucets, drains, etc. Be gently wiped dry with a soft cloth after use to avoid water spotting and water deposit buildup. A mild liquid hand soap, such as Ivory may be used if desired. Use of a non abrasive canauba wax will add protection to the finish and should be used if the faucet will not be dried after use. Santec Orobrass kitchen products are clear coated.

For non -clear coat ed and specialty finishes:

We recommend that all faucets, drains, etc. be gently wiped dry with a soft cloth after use to avoid water spotting and water deposit buildup. Use of a non -abrasive carnauba wax is required occasionally.

Lead Precaution Information:

Most sources of drinking water contain some amounts of lead. Brass faucets, fittings, water meters etc. can create small amounts of lead if the water is allowed to stagnant in them for an extended period of time. We suggest that you **ALWAYS RUN WATER FOR A SECOND OR TWO TO CLEAR THE FAUCET OF STANDING WATER PRIOR TO USE.** This simple procedure will prevent detectable amounts of lead from the faucet entering into the water you consume.

Due to the fact that brass faucets can facilitate allowing detectable amounts of lead into the water, when it is allowed to stand in them for some time, some states like California mandate the following notice;
WARNING: ALL BRASS FAUCETS CONTRIBUTE DETECTABLE AMOUNTS OF LEAD, A CHEMICAL KNOWN TO CAUSE BIRTH DEFECTS OR OTHER REPRODUCTIVE HARM.

Santec has obtained applicable code (standards) listings generally available on a national basis for products of this type. It is the responsibility of the installer/owner to determine specific local code compliance prior to installation of the product. Santec makes no representation or warranty regarding, and will not be responsible for any code compliance.

Some products listed in this catalog may not be approved for use in the state of Massachusetts, check with your Local Authority or Licensed Plumber to assure code compliance.