



Rough Valve Only for 3/4" Volume Control Wall Valve

Rohl Country Bath Collection

A4911BO

FEATURES

- 3/4" F inlet/outlet on/off valve for the A4912, A2912, A4712, A4812, and A4012 trim sets
- Brass valve housing with 1/4 turn ceramic disc control cartridge
- Must order A4912, A2912, A4712, A4812, or A4012 trim set to complete

COLORS/FINISHES

N/A

WARRANTY

- Limited lifetime

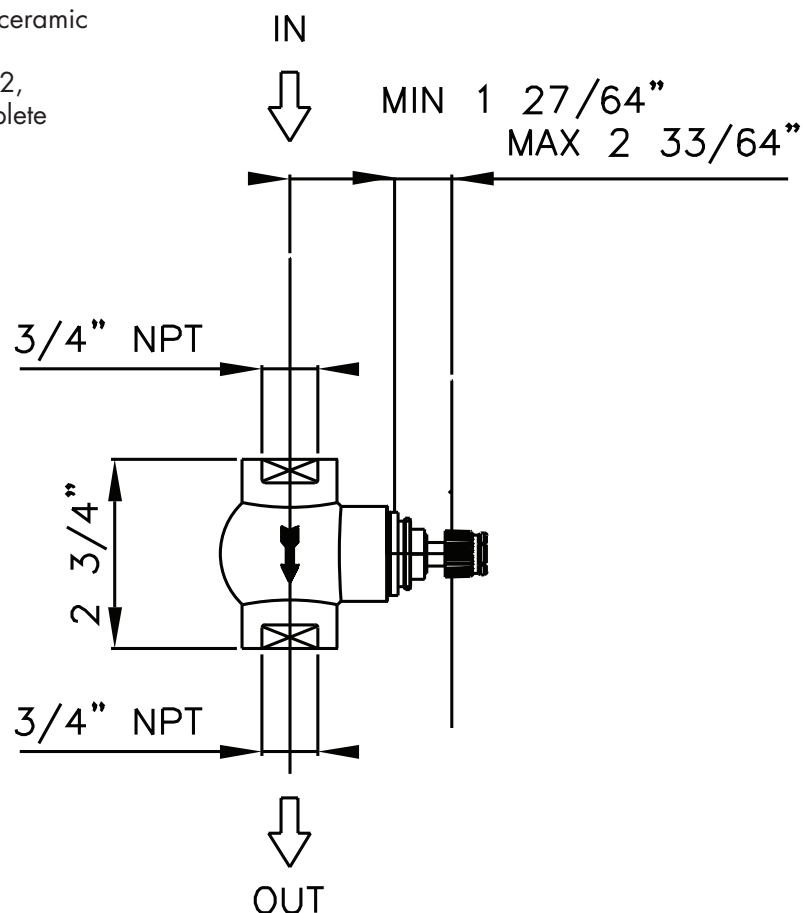

A4911BO Spare Parts

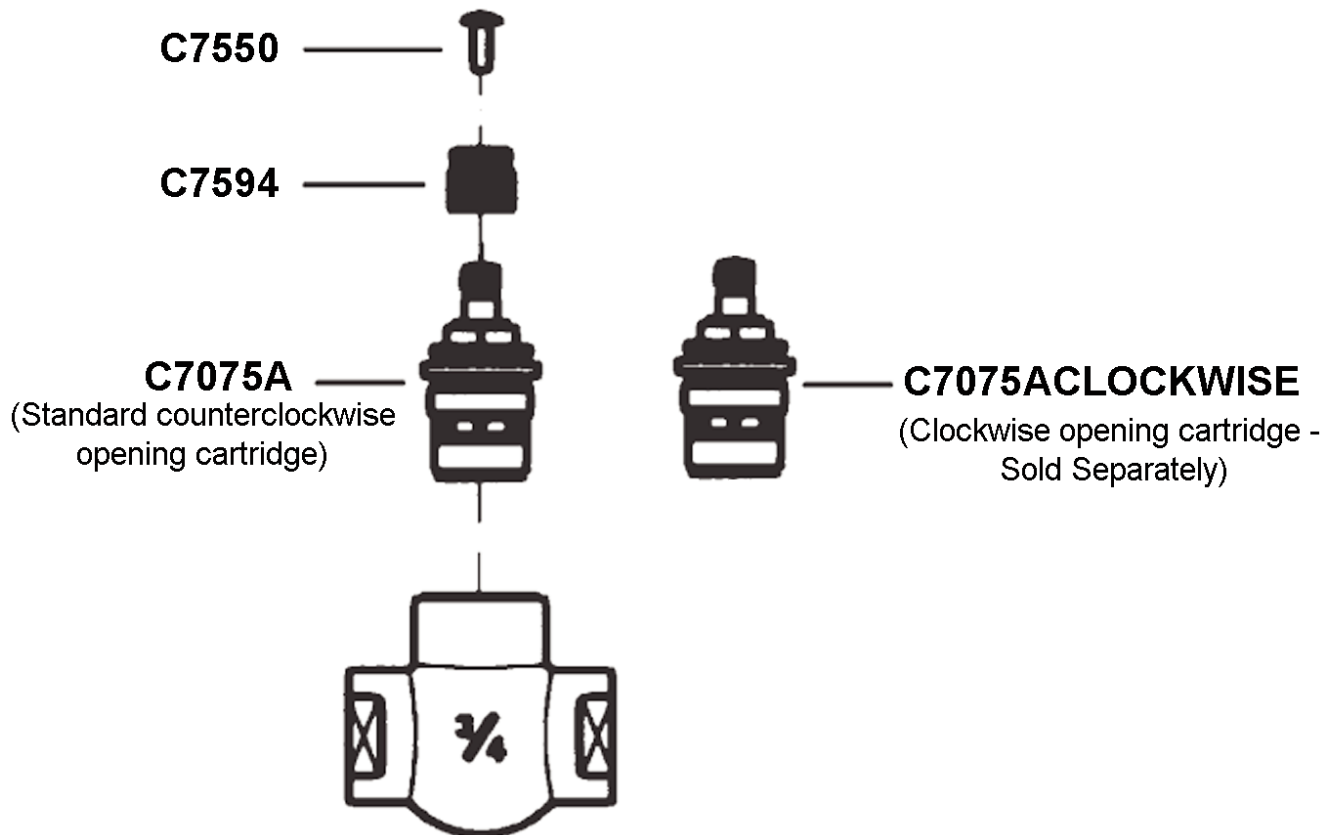

Installation Instructions

INSTALLATION AND CARE & MAINTENANCE GUIDE

Installation Guide

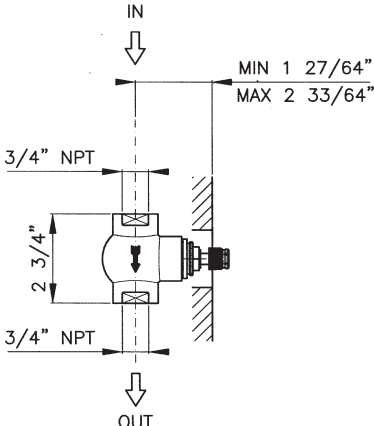
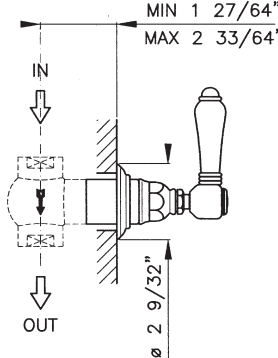
Installation guide											
<p>Volume control inside part</p> <p>Art. A4911BO</p> 	<p>Volume control external part</p> <table border="0"> <tr> <td>Art. A2912XM--TO</td><td>A4712LM--TO</td></tr> <tr> <td>Art. A4912X--TO</td><td>A4912LH--TO</td></tr> <tr> <td>Art. A4912LC--TO</td><td>A2912LM--TO</td></tr> <tr> <td>Art. A4912LM--TO</td><td>A4912XM--TO</td></tr> <tr> <td>Art. A4912LP--TO</td><td>A4912XC--TO</td></tr> </table> 	Art. A2912XM--TO	A4712LM--TO	Art. A4912X--TO	A4912LH--TO	Art. A4912LC--TO	A2912LM--TO	Art. A4912LM--TO	A4912XM--TO	Art. A4912LP--TO	A4912XC--TO
Art. A2912XM--TO	A4712LM--TO										
Art. A4912X--TO	A4912LH--TO										
Art. A4912LC--TO	A2912LM--TO										
Art. A4912LM--TO	A4912XM--TO										
Art. A4912LP--TO	A4912XC--TO										
<p>Preliminary information</p> <ol style="list-style-type: none"> 1. The A4911BO and A4912 trim kit are separate units. You must order both to complete the package. 2. The A4911BO has the adaptor C7594 in the box 3. The A4911BO is port specific. Make sure the arrow points in the direction of the flow. 4. 1 1/2" extension kit C4912 is available. Must order separately. 											
<p>a - Preparation</p> <ol style="list-style-type: none"> 1. Flush the system before and after installation. 											
<p>b - Assembly of inside body</p> <ol style="list-style-type: none"> 1. Estimate the finished wall and install the rough at the required depth. 2. Make sure the arrow on the body point in the direction of the flow. 3. DO NOT SOLDER THE CONNECTIONS: Heating the valve will damage the cartridge. There is no warranty on cartridges damaged by heat. 4. Leave the plastic mudguard in place if further work is done in the area. 											

Installation Instructions

c - Assembly of external part

Please note: The trim kit is assembled out of the box. There are no parts assembled. Parts 2 through 11 are preassembled.

1. Remove the mudguard.
2. Confirm the installation of adaptor C7594.
3. Position the lever at 12 o'clock and screw the body #3 on to the rough valve #1 with the adaptor C7594 in place. Please note: Part #2 is a part of the assembly and not an extension. The extension kit is number C4912 and is not part of the trim assembly. It must be ordered separately.

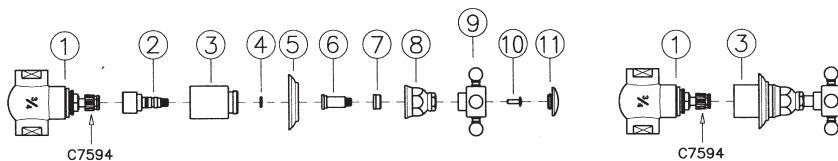

d - Before use

Turn on the water supply to the faucet.
Maximum temperature water supply to the faucet is 145° F.
Maximum recommended pressure is 75 psi.

CHECK THE INSTALLATION CAREFULLY FOR LEAKS AFTER INSTALLATION.

If further building work is to be carried out in the vicinity of the faucet, it should be covered to prevent paint, adhesive, etc. from damaging the surface.

Installation Instructions

Care and use for finishes

Country Bath Products are all authentic finishes that have not been coated with any product.

After each use, pat the fixture down to remove any excess water. This will prevent any water spotting or mineral build-up. Use only soft liquid soap and water to clean the surface. Use a soft brush to clean any gaps. Avoid any products that have ammonia or alcohol like Windex, 409 or Fantastik. These products can damage the finish leaving black or white spots. Never use an abrasive product like Softscrub, Comet, Ajax or Bon Ami.

For deep polishing we recommend Bruno's Wax for all finishings.

Tuscan Brass is a living finish and has no warranty. It will lighten with use. To extend the life of the finish, apply Bruno's Wax by patting it on, letting it dry and patting it off. Never rub or buff this finish.

WARNING: the use of cleaning products not recommended might irreparably harm the surfaces of the faucets which in such case are not covered by our warranty.

Limescale

The faucet is fitted with an aeration device in the Hot/Cold water outlet.

This may need occasional cleaning especially in hard water areas.

This is accomplished by unscrewing the outlet in a counter clockwise direction, dismantling and leaving the inner screen mesh immersed over night in vinegar or lemon juice.

Do not use chemical descaling liquids for this purpose.

Installation Instructions

ATTENTION

READ THESE INSTRUCTIONS BEFORE INSTALLATION AND USE OF ALL FAUCETS AND WALL VALVES

INSTALLATION and WARRANTY INSTRUCTIONS TECHNICAL INFORMATION

All flexible hoses are designed and manufactured for use with water in exposed locations only. **Do not expose** to household cleaners, chlorine, chloride, hydrochloric acid or other corrosive chemicals.

- All connections with threads M10x1 male must be hand tighten. **Do not over tighten. Over tightening may cause damage to the hose.**

All faucets washers and o-rings are designed and manufactured for use with water. **Do not expose** to household cleaners, chlorine, chloride, hydrochloric acid or other corrosive chemicals.

Faucets are designed for use with the temperatures and pressures listed below:

- minimum cold water supply 50 °F
- maximum hot water supply 145 °F
- minimum pressure 15 psi
- maximum pressure 75 psi
- maximum fixing torque value = 10 lbf.ft.
-

Please note: The recommended best pressure for best performance is between 40 psi and 60 psi. More pressure than 60 psi or less pressure than 40 psi may affect the diverting action in side spray faucets.

- ☐ Do not use any Rohl Country/ Nicolazzi faucet with sulphurous water.
- ☐ The minimum temperature for all faucets is 50 degrees F. Below 50 degrees F will void the warranty.
- ☐ When available, filter systems must be placed between hot and cold supply lines and the faucet. Improper use or non-use of filters may make diverting faucets with hand sprays perform poorly.
- ☐ Don't modify faucet and their components
- ☐ Use only original spare parts if there are replacements to be ordered.
- ☐ Installation must be made by authorized plumbers or installers. Improper installation or diagnosis of problems is not covered by the warranty.
- ☐ Yearly maintenance of cleaning and flushing is recommended.

Operation and use of any faucet or wall valve that do not conform to these technical instructions will void the warranty.